

cryoICE[®] BOX Quick Start Guide

AtriCure

Scan QR code to view
AtriCure's cryoICE BOX
Quick Start Guide Video

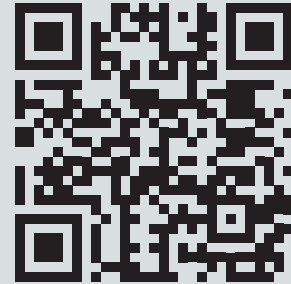

cryoICE BOX Set-Up Sequence

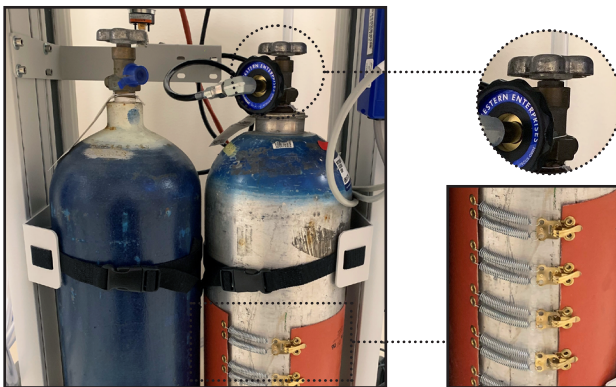

1. Open tank

- Open valve “all the way open”
- Active tank should have orange heater band on it. Verify valve assembly is attached to tank with orange heater band.



2. Turn on machine

- Turn on power switch located on back of unit
- cryoICE BOX should be set up at least 15-minutes prior to the procedure

Note: Be sure to route the N₂O vent tubing to a safe area prior to use.

cryoICE BOX Set-Up Sequence Continued

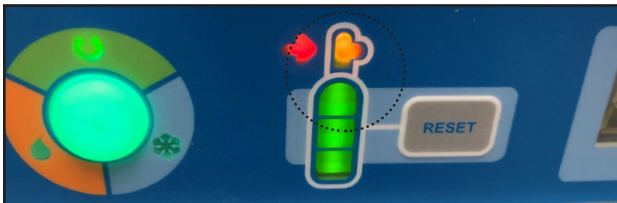

3. Verify tank indicator

Note: Flashing tank indicates the tank is closed. Open tank valve to resolve.



4. Connect probe

- Connect probes to color matching connections
- A. Thermocouple connectors: Red to red and black to black
- B. Orange exhaust connector: push back locking collar prior to connecting
- C. Blue inlet connector: pushes straight in

Note: Pull back on orange and blue connectors after connecting to verify good connection.

Refer to ACM Cryo Console – Technical Reference Guide for troubleshooting tips for connecting probe.

Note: Be sure to route the N₂O vent tubing to a safe area prior to use.

cryoICE BOX Operation

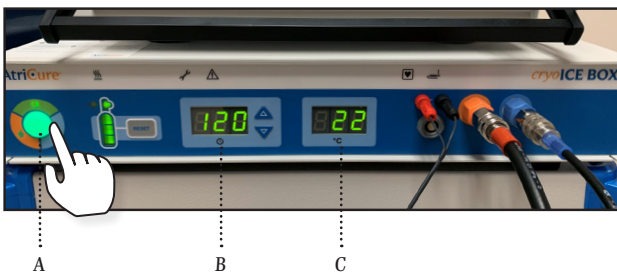

1. Start a freeze cycle

- A. Press “Start/Stop” button to initiate the freeze cycle (button will turn blue)
- B. Timer starts when temperature reaches -40°C
- C. Temperature display

Refer to ACM Cryo Console – Technical Reference Guide for troubleshooting tips



2. Freeze completed, auto-defrost cycle begins

- A. When timer hits “0”, machine will go into defrost (orange) mode and begin to warm probe to 10°C before returning to green ready status

Note: Wait until “Start/Stop” button turns green before beginning a new freeze cycle



3. Aborting a freeze cycle

- A. Freeze can be stopped at any time by pressing “Start/Stop” button once
 - Machine will initiate a defrost cycle (orange) and return to ready status (green)

cryoICE BOX Purge and Power Down Sequence

Note: Leave unit powered ON until purge sequence is completed



A B

1. Disconnect probe

- A. Disconnect all connections and discard probe (single use device)
- B. Push locking collars of **orange** and **blue** connectors towards cryoICE BOX to disconnect

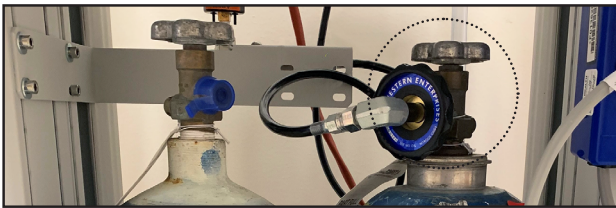

2. Close tank

- Close valve completely (turn to right)

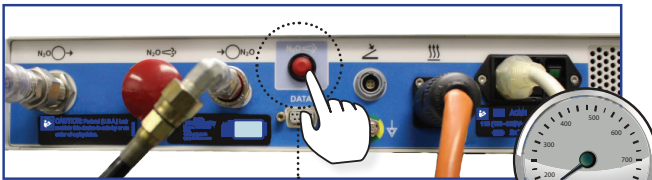

A

3. Purge gas from machine

- A. Press and hold vent button until gas gauge stops moving
 - Gas gauge is mounted on cart frame



4. Turn off machine

See AtriCure Cryo Module (ACM) User's Manual for a complete list of safety related instructions and instructions for use.

This Page Intentionally Left Blank